

Current part is item (3) on diagram. Available at [www.oshkoshequipment.com](http://www.oshkoshequipment.com)

(1) (a) FIG. NO.	(2) (b) ITEM NO.	(3) SMR CODE	(3) NATIONAL STOCK NUMBER	(4) PART NUMBER	(5) FSCM	(6) DESCRIPTION USABLE ON CODE	(7) U/M	(8) QUANTITY INC IN UNIT
GROUP 47-GAGES(NON-ELECTRICAL), WEIGHING AND MEASURING DEVICES								
4701-INSTRUMENTS								
344	1	PAOZZ	5310-00-959-7600	MS51922-5	96906	NUT, SELF-LOCKING AB, AC	EA	3
344	2	PAOZZ	5305-00-068-0505	MS90726-5	96906	SCREW, CAP, HEXAGON HEAD AB, AC	EA	3
344	3	PAOZZ	5340-00-088-1254	MS21333-104	96906	CLAMP, LOOP AB, AC	EA	3
344	4	PAOZZ	6680-00-732-0561	MS51071-5	96906	SHAFT ASSEMBLY, FLEXIBLE: TACHOMETER TO ENGINE DRIVE ADAPTER AB, AC	EA	1
344	5	PAOZZ	5310-00-753-9688	7539688	19207	WASHER, FLAT: SEALING AB, AC	EA	1
344	6	PAOZZ	5310-00-532-9467	5329467	19207	WASHER, SLOTTED AB, AC	EA	1
344	7	PAOZZ	5330-00-753-9689	7539689	19207	GASKET: GEAR COVER TO TACHOMETER DRIVE PLUG AB, AC	EA	1
344	8	PAOZZ	6680-00-882-0961	MS51072-5	96906	CORE FLEXIBLE, SHAFT ASSEMBLY: TACHOMETER DRIVE SHAFT AB, AC	EA	1
344	9	PAOZZ	5325-00-174-9038	MS35489-20	96906	GROMMET, RUBBER AB, AC	EA	1
344	10	PAOZZ	6680-00-825-2076	MS35916-2	96906	TACHOMETER, MECHANICAL, FIXED MOUNTING AB, AC	EA	1
344	11	PAOZZ	5310-00-934-9751	MS35650-302	96906	NUT, PLAIN, HEXAGON AB, AC	EA	2
344	12	PAOZZ	5310-00-045-3296	MS35338-43	96906	WASHER, LOCK AB, AC	EA	2
344	13	PAOZZ	7690-00-924-4318	10932058	19207	DECAL: TACHOMETER WARNING DANGER AB, AC	EA	1
345	1	PAOZZ	5330-00-011-5449	115449	21450	GASKET: GEAR COVER TO TACHOMETER DRIVE ADAPTER AB, AC	EA	1
345	2	PAOZZ	6620-00-084-7621	10912497	19207	ADAPTER, TACHOMETER TAKE-OFF AB, AC	EA	1
345	3	PAOZZ	2815-00-995-1811	11610078	19207	ADAPTER ASSEMBLY, TACHOMETER: RIGHT ANGLE DRIVE AB, AC	EA	1
346	1	PAOZZ	2520-00-562-0421	7061216	19207	ADAPTER, ANGLE DRIVE, SPEEDOMETER: DRIVE RATIO 0.167 TO 1 (SAME AS ADAPTER, P/N 7065893 (19207), EXCEPT WHERE INDIVIDUAL COMPONENTS ARE ANNOTATED)	EA	1
346	1	PAOZZ	2520-00-404-3098	7065893	19207	ADAPTER, SPEEDOMETER: DRIVE RATIO 0.200 TO 1 (USED ON VEHICLES THROUGH SERIAL NO. 90802) (M34, M44, M47, V17A/MTQ, V18A/MTQ)	EA	1
346	2	PAOZZ	2520-00-737-2729	7372729	19207	SHAFT, DRIVE, SPEEDOMETER: SLIDING, DRIVE ADAPTER (USED ON ADAPTER, P/N 7065893 (19207), ONLY)	EA	1
346	2	PAOZZ	2520-00-706-5894	7065894	19207	SHAFT, SPEEDOMETER ADAPTER: SLIDING, DRIVE ADAPTER (USED ON ADAPTER, P/N 7061216 (19207), ONLY)	EA	1

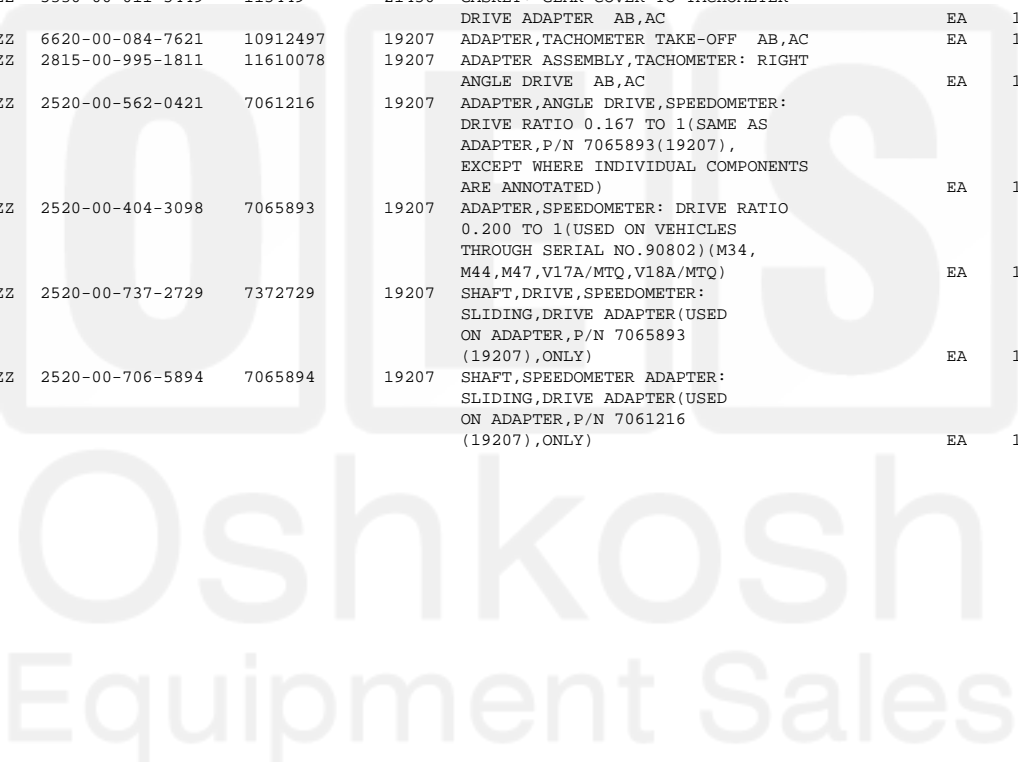

Current part is item (3) on diagram. Available at [www.oshkoshequipment.com](http://www.oshkoshequipment.com)

TM 9-2320-209-201

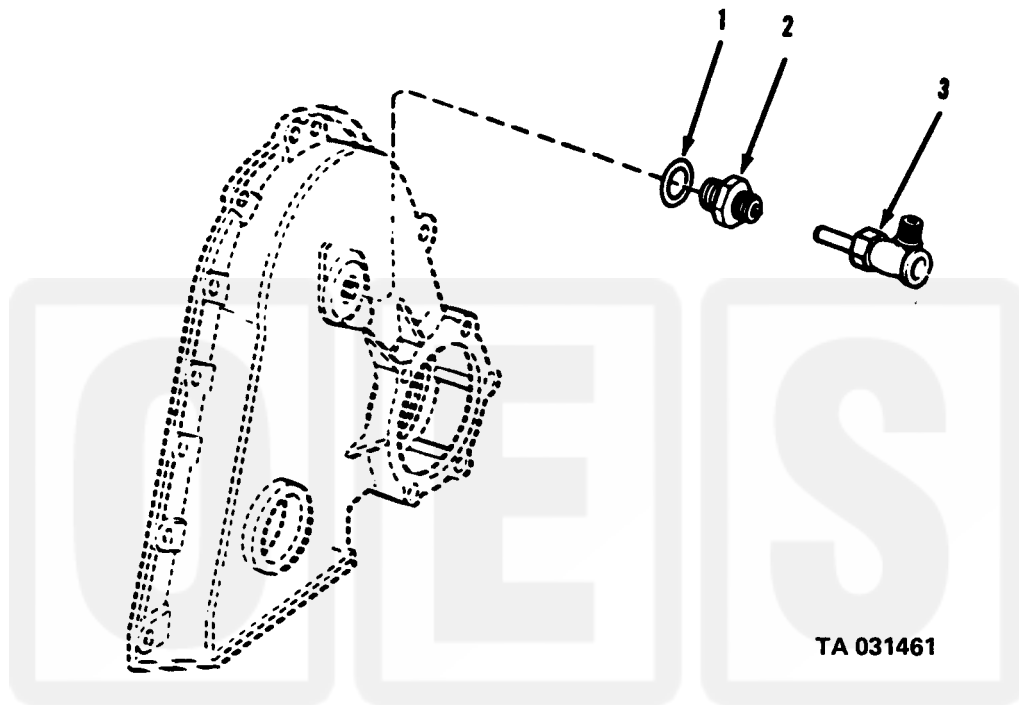

Figure 345. Tachometer drive and take-off adapter.

Oshkosh  
Equipment Sales